

INSTALLATION INSTRUCTIONS

DESCRIPTION: Poly Windshield Kit
PART NUMBER: B4J-F83J0-V0
MODEL: 2021+ Wolverine X4, X2, R-Max



⚠ WARNING

Please read and understand these instructions completely before installation to avoid possible injury, or damage to the accessory or vehicle.

WARRANTY INFORMATION:

In the United States, see your Yamaha dealer for a copy of the Yamaha Genuine Parts and Accessories

NOTICE:

This installation requires a torque wrench and should be performed by an authorized Yamaha dealer or other qualified technician.

DEALER OR INSTALLER:

These instructions contain important information for future reference and *must* be given to the customer.

PARTS LIST:

No.	Part Number	Description	Qty
--	B4J-F83J0-V0	Poly Windshield Kit	--
①	-	Windshield w/Top and Bottom Bulb Seals	1
②	BG4-F72C2-V0	Clamp	4
③	90111-06821	M6x16mm Button Head Hex Socket	8
④	90201-068G7	M6 Washer	8

* Part supplied with kit only and not available separately.

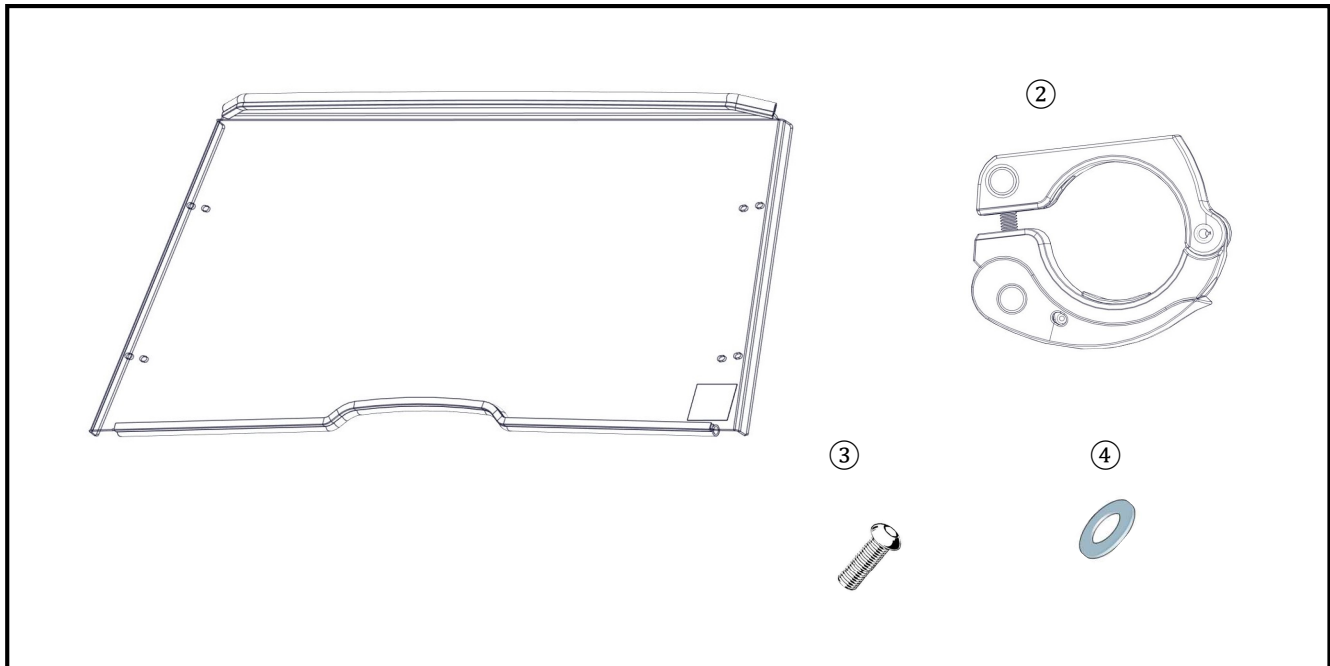

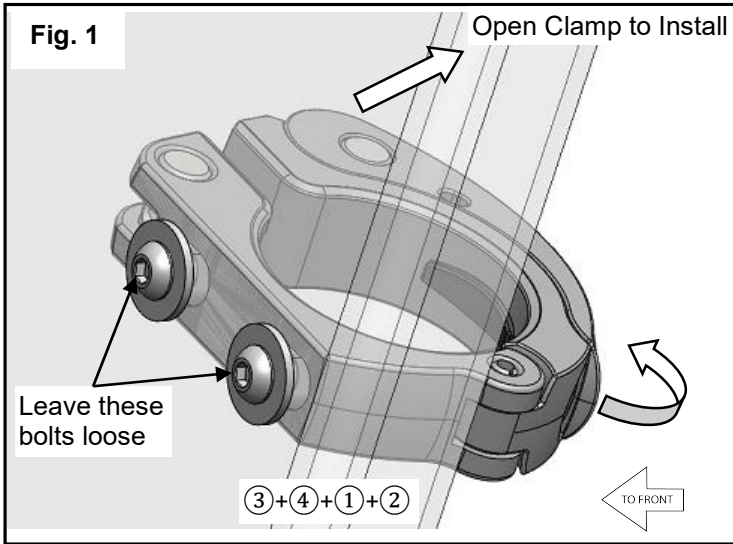

PREPARATION:

- Place the vehicle on a secure and level surface.
- Set the parking brake.
- Clean the mount surfaces before starting installation.

INSTALLATION:

1. Assemble four (2) Clamps to (1) Windshield. Leave the bolts loose enough to allow the clamps to move during installation. (Fig. 1)

Note: Open the clamps as shown in Fig. 4.

2. Install (1) Windshield to ROPS. Leave the (2) Clamps loose. Insert the (1) Windshield into the channel on hood with enough force to compress the lower seal. (Fig. 2)

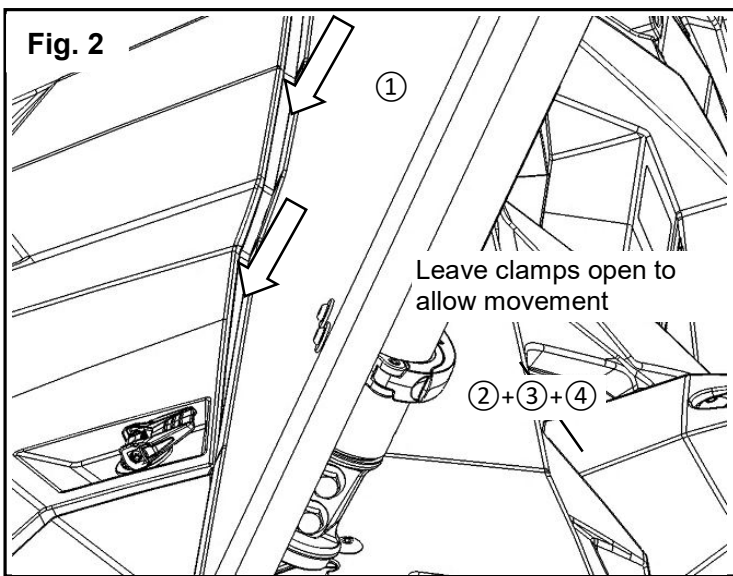

3. Ensure that the top of the bulb seal on the (1) Windshield seals underneath the Suntop. (Fig. 3)

4. When you are satisfied with the position of the (1) Windshield, close the (2) Clamps.

5. If a (2) Clamp is too tight or too loose, open and rotate the latch handle cam until the clamp has proper tension when secured. (Fig. 4)

6. Torque all (3) Button Head Screws to 6Nm (0.6 kg-m or 4.4 lb-ft).

Notice:

- Windshield may only be mounted in the forward position during towing and when used in conjunction with the Sun Top. Failure to use in conjunction with the Sun Top may result in cracking and failure of windshield at highway speeds. Remove the windshield if there is no Sun Top installed.
- Both sides of windshield can get dirty quickly in dusty or muddy conditions. When operating in such conditions, carry fresh water and towels to clean the windshield if vision becomes impaired. Driving with impaired vision can result in an accident.

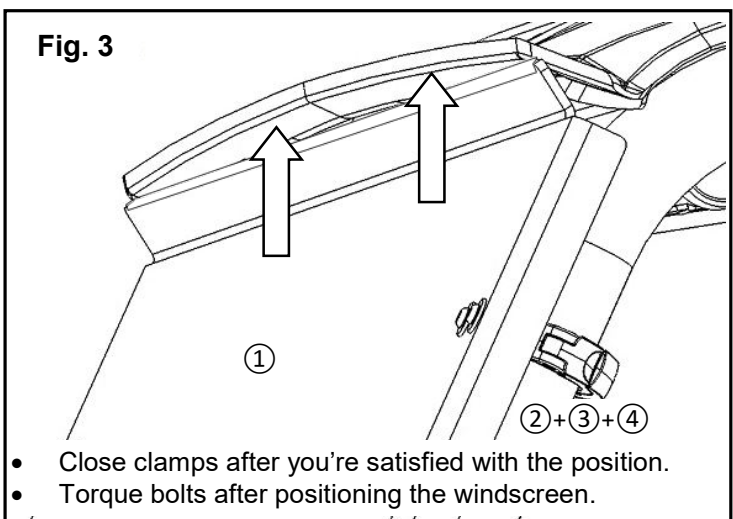

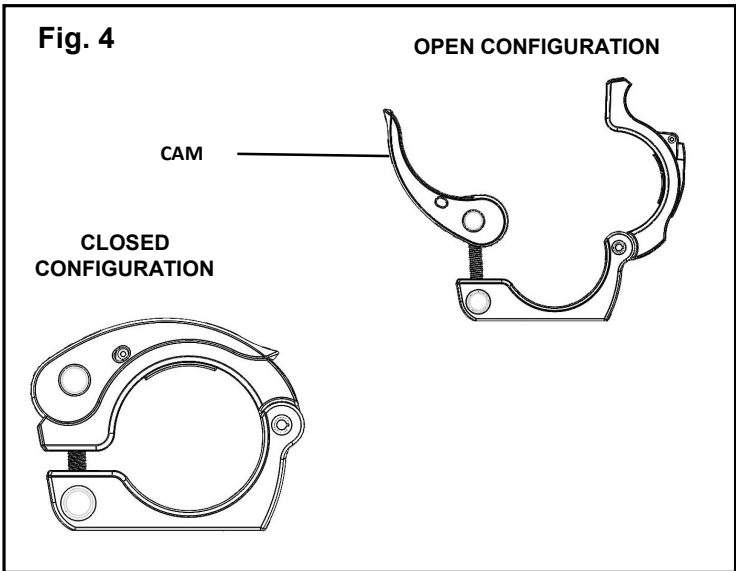

MAINTENANCE:

Periodically, check torque and tightness on all hardware. If loose hardware is found, re-torque or re-tighten.

CARE AND CLEANING:

Use a clean soft cloth and mild detergent with warm water to clean the windshield. Rinse and dry. Yamaha Windshield & Visor Plastic Cleaner & Conditioner (p/n ACC-PLASP-OL-11) is recommended to clean the windshield. Cleaning with alkaline or acid cleaner, gasoline or solvent will damage the windshield.

CUSTOMER SERVICE:

ESTIMATED TIME TO INSTALL: 0.3 HR